

Krebs Custom, Inc.

1000 Rand Rd., #106

Wauconda, IL 60084

Ph: 847-487-7776

Fx: 847-487-7778

krebscustom@krebscustom.com

Note: The Krebs Custom Trigger Pin Retaining Plate is **NOT** for use with full-auto firearms.

To install your Krebs Custom Trigger Pin Retaining Plate:

Remove magazine and cycle the action several times, then *visually* check to make sure your rifle is unloaded.

Field-strip your rifle in the usual manner

Rotate the safety tab upward to a “vertical” position.

If the safety doesn’t rotate to the vertical, withdraw the trigger pin from the left side of the receiver, BUT NOT ALL THE WAY OUT. Move the trigger forward as far as you can to clear the disconnecter so it can disengage from the safety. Remove the safety by pulling it straight out of the rifle to the right. Push the trigger pin back into place, making sure the “shepherd’s hook” retaining wire is back in its proper place on the trigger pin.

Remove the old “shepherd’s hook” retaining wire (there are too many variations of these types of pin retainers to list).

Once your pin retainer is out of the rifle, re-assemble the rifle with the hammer in the forward (fired) position and the pins fully seated. Take the “forked” end of the TPRP (Figure 1 – on back) and wiggle it between the side of the receiver and the hammer spring so that each side of the fork goes into the pin group (Figure 2).

Sometimes, to seat the TPRP fully, it is necessary to rock the hammer back & forth to help it move into position.

Rotate the back end of the TPRP into the notch in the trigger pin (Figure 3).

Insert the rifle’s safety into the receiver. Align the pin section with the hole in the TPRP and the hole in the receiver until the lever is flush against the receiver.

At that time (and only then) rotate the safety forward and down, and back into position.

(Note: due to manufacturing tolerances between US-made receivers, installation of the TPRP may require some fitting. If this is the case, contact Krebs Custom for assistance.)

AFTER INSTALLATION: Using a small non-marring punch and a hammer, give each pin several light taps on the **right** side of the rifle to insure that the pins are properly seated and retained by the Trigger Pin Retaining Plate.

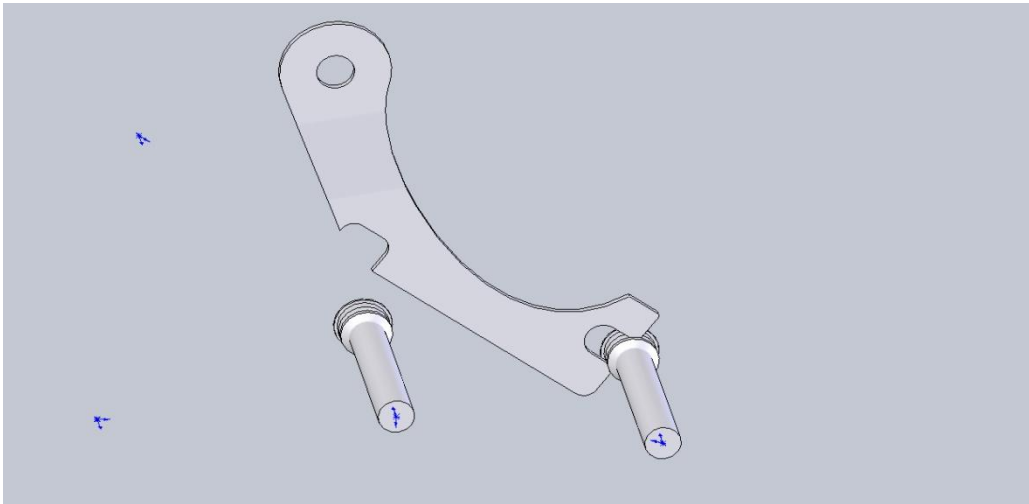

Figure 1

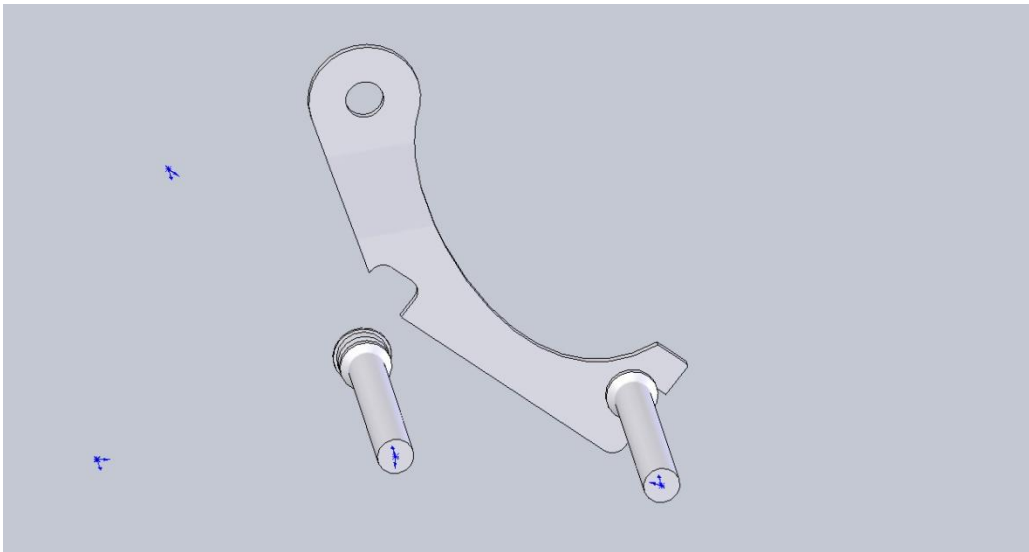

Figure 2

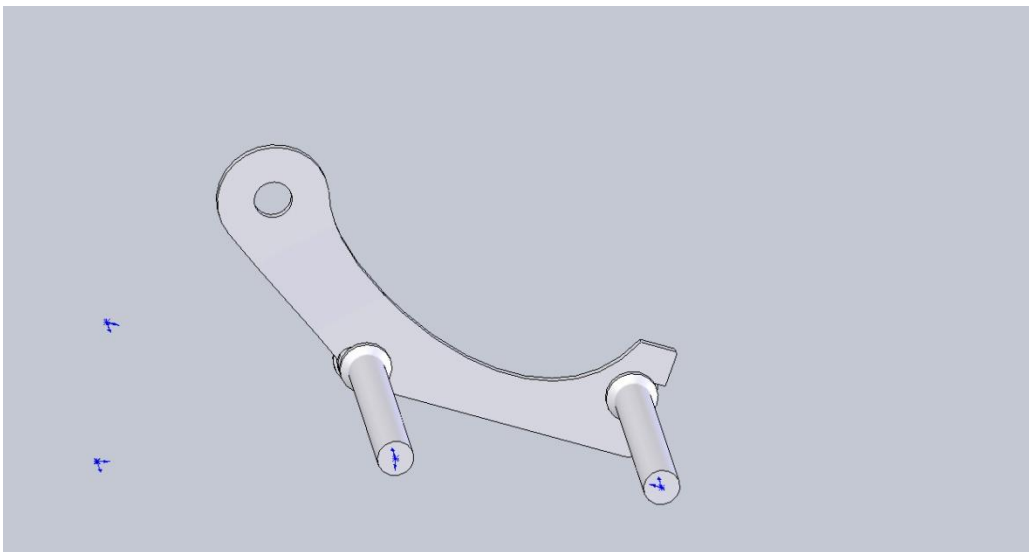

Figure 3