

LEE ERGO-PRIME

WHEN PRIMING CASES, HANDLE AS A LOADED GUN. NEVER POINT AT YOURSELF OR ANYONE ELSE. PRIMERS WILL EXPLODE IF SHOCKED OR CRUSHED. WEAR EYE & EAR PROTECTION AT ALL TIMES WHEN PRIMING OR HANDLING PRIMERS.

STOP

Before you squeeze the lever of your Ergo Prime, see the pictures at right.

The lever must depress effortlessly until hole in the connecting link is not visible. If you meet any resistance a primer is pinched. **STOP, DO NOT APPLY ANY MORE PRESSURE! CONTINUED PRESSURE WILL DAMAGE TOOL**

Release lever with tool at a 45° angle to ground, allow next primer to completely feed into the elevator slide. Squeeze lever, if you meet no resistance, you can continue priming.

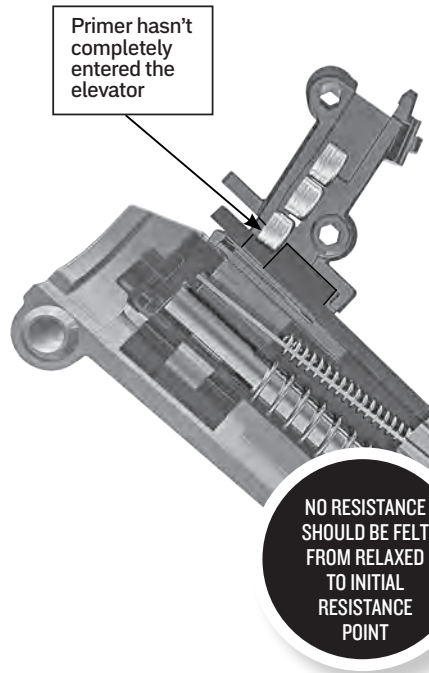

NO RESISTANCE SHOULD BE FELT FROM RELAXED TO INITIAL RESISTANCE POINT



1 Occasionally lubricate connecting rod wear point using household multi-purpose oil.

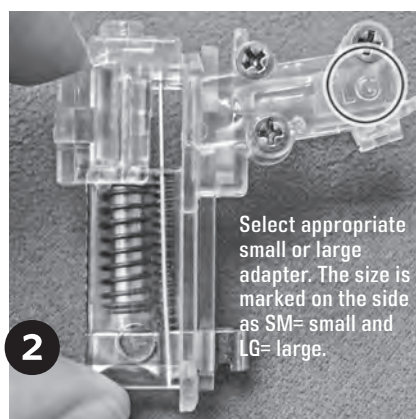

2 Select appropriate small or large adapter. The size is marked on the side as SM= small and LG= large.



3 Slide adapter into the body of the tool far enough to install appropriate shell holder.



4 Slide the flow control **OPEN**

Before filling the tray, consult the primer manufacturer's warning to verify primers can be safely tray fed. If tray use is not an option; feed primers individually by leaving folding tray open and placing a primer smooth side down on tray. See below, ↓

SINGLE PRIMING OPTION



Slide flow control valve to the **ON** position

WARNING Primer dust accumulation can detonate. Regularly clean tray and tool to prevent accumulation. The dust contains lead; a substance known to cause birth defects, reproductive harm and other serious physical injury. Wash hands after exposure.

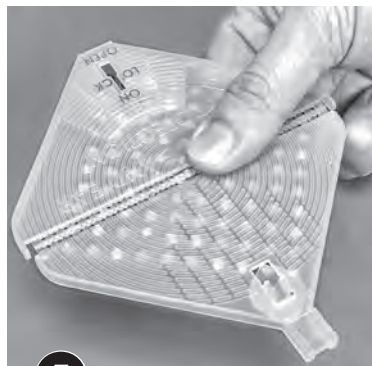

5 Unfold tray and place on top of box of 100 primers.

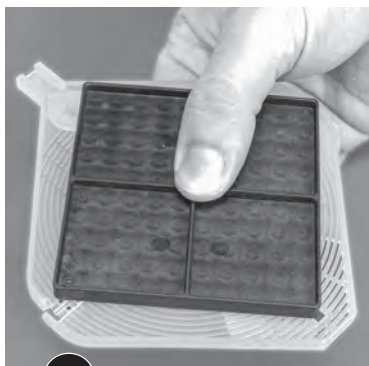

6 Flip tray over to deposit the primers.

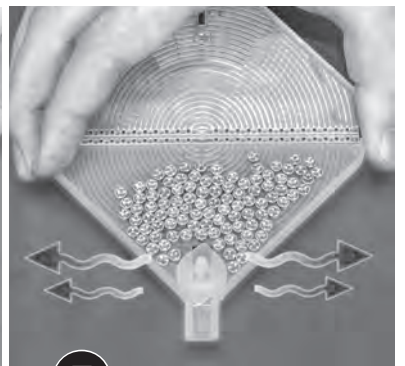

7 Shake tray side to side to upright all the primers. Fold and close cover. Slide the flow control to **LOCK**

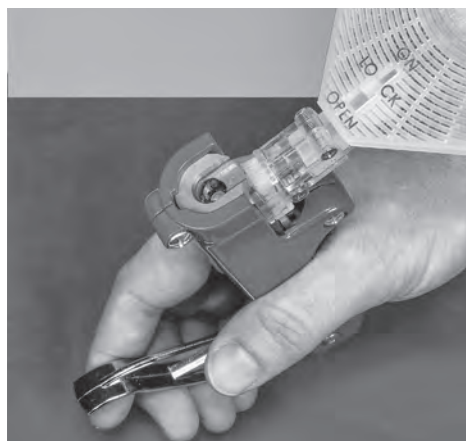

8 Slide primer tray into adapter; slide flow control to ON, and tip the tool forward to watch the flow of primers from tray into adapter.



Place a deprimed case into shell holder. Squeeze lever to seat primer. Primers should be seated flush to slightly below flush of the case head. Lever will not bottom out and you will quickly learn to feel when primer has reached home by the increase in pressure on lever.

WARNING If you feel an increase in pressure on the lever earlier than normal, you have a problem and continued pressure may result in a primer detonation. Stop pressing and determine what is causing the early increase in pressure. It is likely a tipped primer, a military case that does not have its crimp completely removed, or attempting to prime an already primed case.

LEE ERGO-PRIME

The Ergo-Prime (PATENT PENDING) is designed to reduce the likelihood of a mass detonation when priming cases. This is accomplished by remotely locating the mass of primers during the priming operation. A separate elevator raises a single primer from the tray and presents it for priming.

We have tested the tool by intentionally setting off a variety of brands and types of primers. Our testing has demonstrated that wearing safety glasses and hearing protection will prevent serious injury.

! However, all types of FEDERAL BRAND LARGE primers frequently caused the entire tray to explode with sufficient force to cause serious and painful injuries.

THIS TOOL REQUIRES SPECIAL, INEXPENSIVE SHELL HOLDERS
Always wear safety glasses and hearing protection when handling primers or priming cases.

SHELLHOLDERS

HOLDER	RIFLE	HOLDER	RIFLE	HOLDER	RIFLE
20	17 Hornet	5	7 x 61 Sharpe & Hart	5	375 Ruger
4	17 Remington	5	7mm Rem. Magnum	14	38/40 Win.
4	204 Ruger	5	7mm Win S Mag	3	38/55 Winchester
20	22 Hornet	5	7mm Weatherby	8	40/82 Winchester
20	22 K Hornet	5	7mm Ultra Mag	5	416 Remington
3	22 Savage	2	284 Winchester	25	416 Rigby
2	22 BR	3	7.5mm Schmidt-Rubin	18	43 Mauser
6	218 Bee	7	30 M 1 Carbine	17	43 Spanish
12	22 PPC	3	7.65x53 Arg. Mauser	14	44/40
3	219 Zipper	12	7.62mm x 39	11	444 Marlin
10	220 Swift	16	7.62x54 Russian	8	45/70 Gov't
4	221 Fireball	3	30 Herrett	5	458 Win. Magnum
4	222 Remington	3	30/30 Win. (30 WCF)		
4	222 Rem. Magnum	2	300 Savage	HOLDER	PISTOL
4	223 (5.56mm)	16	30/378	15	5.7 x 28
5	223 WSSM	21	30 Remington	1	22 Rem. Jet
2	224 Clark (22/257)	2	308 Win. (7.62 NATO)	15	25 ACP
10	225 Winchester	4	300 AAC Blackout	1	256 Win. Magnum
2	22/250	5	30/40 Krag (30 U.S.)	19	30 Luger
2	240 Weatherby	2	30/06 Springfield	19	30 Mauser
2	243 Win.	5	300 H & H	4	32 Short Colt
5	243 WSSM	5	300 Weatherby	4	32 Long Colt
2	6mm Remington	5	300 Win. Magnum	4	32 S & W
2	244 Remington	5	300 Ultra Magnum	4	32 S & W Long
2	6mm Int'l	5	300 Win S Magnum	7	32 ACP
2	6mm/284	5	308 Norma Magnum	4	32 Colt N.P.
2	6mm/06	5	303 British	4	380 Auto
12	6 PPC	2	7.7 Japanese	19	9mm LUGER
4	6 x 47 (6mm/222M)	3	32 Win. Spc'l	1	38 S & W
2	25/284	3	32 Win. S.L.	1	38 Colt N.P.
2	25/06	6	32/20 (32 W.C.F.)	19	38 Super Auto
6	25/20 Winchester	3	32/40 Winchester	19	38 ACP
2	250 Savage	2	8 x 57 Mauser	1	38 Short Colt
3	25/35	2	8mm 06	1	38 Long Colt
2	257 Roberts	2	8mm Man. Schoe.	1	38 Special · 357 Mag
5	257 Weatherby	5	8mm Rem. Magnum	19	357 Sig
5	303/25	17	8mm Lebel	2	357 Auto Magnum
2	6.5mm 06	16	8x56R Hungarian	19	40 S&W · 10mm Auto
2	6.5mm x 57	8	33 Winchester	1	41 Long Colt
3	6.5 x 55 Mauser	25	338 Lapua	19	41 Action Express
10	6.5 Jap.	5	338 Win. Magnum	9	41 Magnum
5	6.5 Rem. Magnum	5	338 Ultra Magnum	11	44 S&W Spl · 44 Mag
2	6.5 Carcano	5	340 Weatherby	11	44 S & W Russian
12	6.5 Grendel	8	348 Win.	2	44 Auto Mag.
5	264 Win. Magnum	2	35 Remington	2	45 Auto
21	6.8 SPC	5	35 Winchester	11 & 14	45 Colt
2	270 Winchester	2	35 Whelen	11	454 Casull
5	270 Weatherby	5	350 Rem. Mag.	14	460 S&W
5	270 Win S Mag	3	356 Winchester	5	455 Webley
2	280 Remington	2	358 Winchester	13	45 Auto Rim
2	7mm/08	5	358 Norma Magnum	3	45 Win. Magnum
2	7mm BR	3	375 Winchester	5 & 16	480 Ruger
4	7mm TCU	5	375 H & H	5	475 Linebaugh
3	7 x 30 Waters	5	375 Weatherby	16	500 S&W
2	7 x 57mm Mauser	5	375 Ultra Magnum		



PARTS LIST

Body	PT2955
Lever	PT2953
Connecting Rod	PT2954
Folding Primer Tray (2 Pack)	90606
Tray & Adapter Set	90794
Instructions	PT3085

SHELL HOLDER	AUTO-PRIME ERGO PRIME	AUTO BENCH PRIME
#1	90201	
#2	90202	
#3	90203	
#4	90204	
#5	90205	
#6	90206	
#7	90207	
#8	90208	
#9	90209	
#10	90210	
#11	90211	
#12	90212	
#13	90213	
#14	90272	
#15	90017	
#16	90200	
#17	N/A	
#18	N/A	
#19	90023	
#20	90020	
#21	90031	
#22	N/A	
#23	N/A	
#24	SH2110	
#25	SH2426	

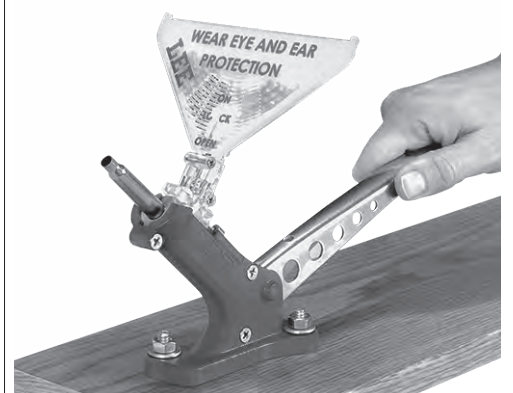

Lee Auto Bench Prime 90700